

How to Use the Z-Axis Extension Module

snapmaker

Foreword

This is a guide on how to use the Z-Axis Extension Module on your Snapmaker Original. It is divided into two sections:

1 Provides information on assembly.

2 Demonstrates the configuration of Snapmaker Luban.

Used Symbols

Caution: Ignoring this type of message might result in malfunction or damage of the machine and injuries to users

Notice: Details you should be aware of throughout the process

 Make sure that the highlighted part is facing the right way.

01 Assembly

1 Make sure that the machine is powered off. Unplug all the cables.

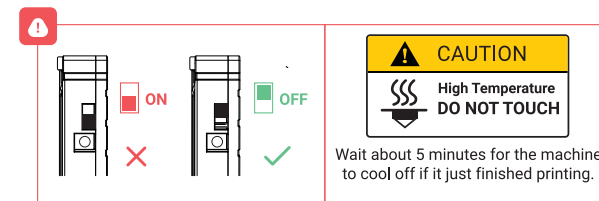
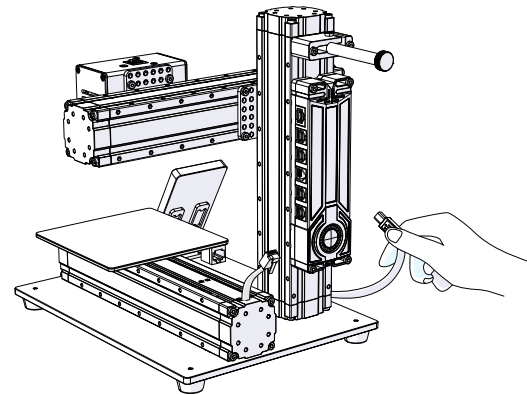

- 2
- Detach the Filament Holder.
 - Detach the X-Axis (with 3D Printing Module attached).
 - Detach the Controller.

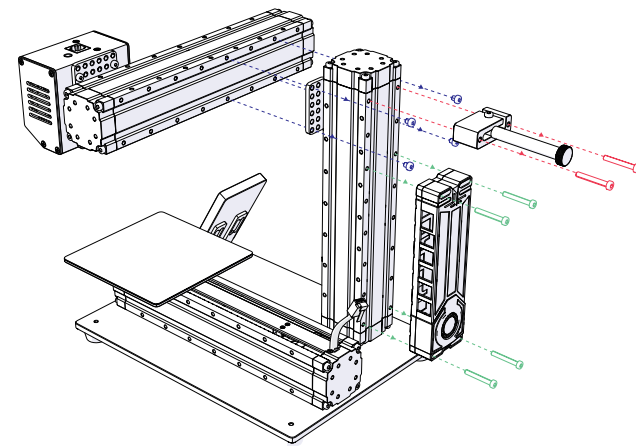

3 Detach the previous Z-Axis. Attach the Z-Axis Extension Module (Z-Axis thereafter).

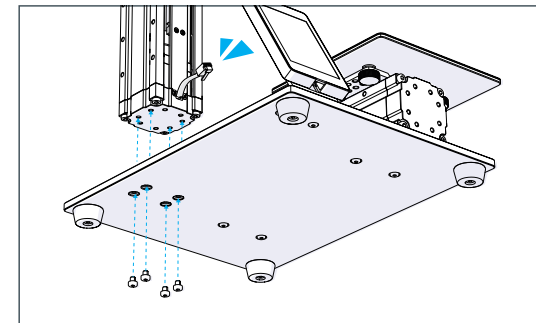

4 Attach the Filament Holder onto the Z-Axis.

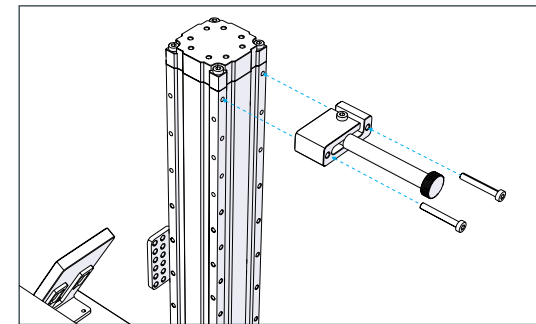

5 Attach the X-Axis (with 3D Printing Module attached) to the Z-Axis.

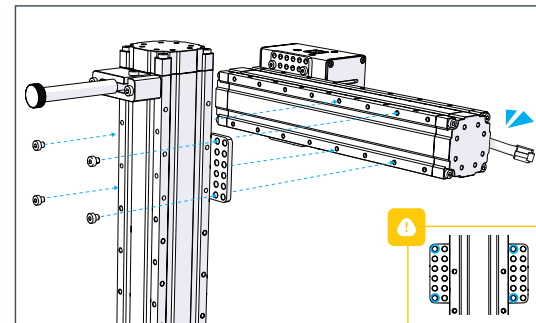

6 Attach the Controller to the Z-Axis.

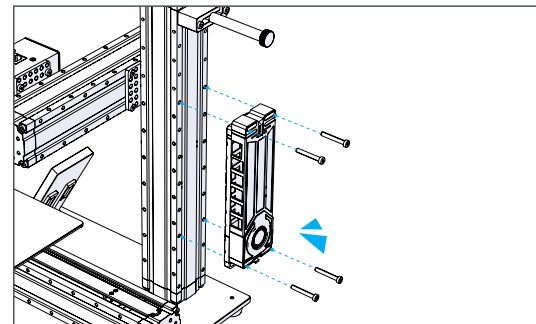

- 7 Connect all the cables unplugged in Step 1.

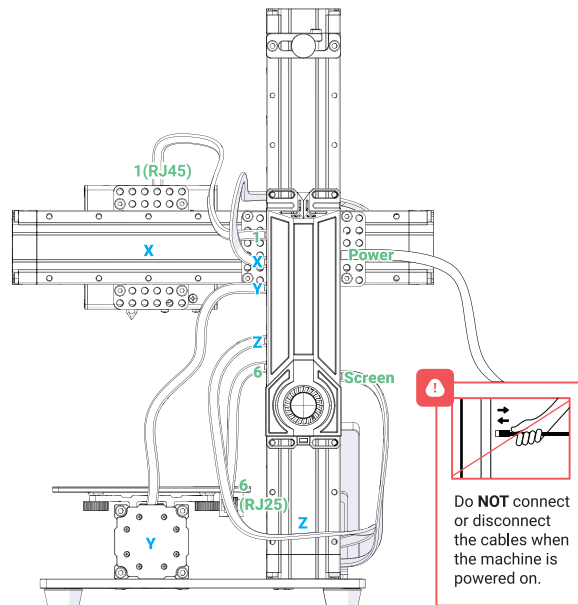

6

02 Configuration of Luban

- 1 Make sure that your firmware is updated to the latest V2.11, and that Snapmaker Luban is installed:
<https://snapmaker.com/product/snapmaker-original/downloads>.
- 2 Connect your PC with the machine using the provided USB cable, and switch the power on.

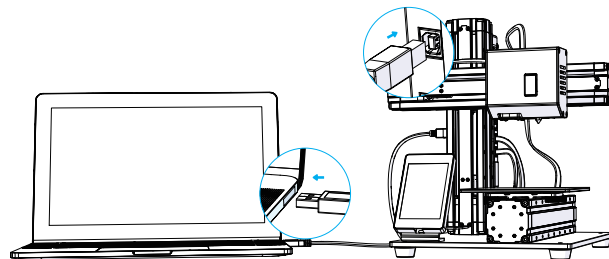

7

Note: If you fail to find serial port of your machine, try and install CH340 driver at:
<https://snapmaker.com/product/snapmaker-original/downloads>.

- 3 - Launch Snapmaker Luban.
- From the left sidebar, enter **Workspace**.
- On top left, find **Connection** and click the refresh button to reload serial ports list.
- Click the drop-down button and select the serial port of your machine, and click **Connect**.

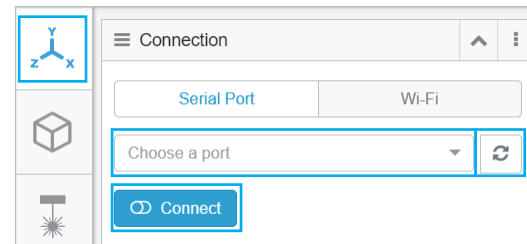

8

- 4 Select **Custom** and the toolhead connected to the machine when prompted.

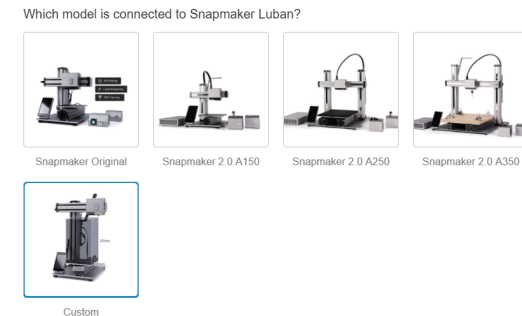

- 5 - Click **Settings** on the left sidebar, choose **Machine Settings**.
- Type **125, 125, 221** separately in the blank spaces under **X, Y, and Z**.
- Under **Z axis Extension Module**, click the drop-down button and select **On**.
- Click **Save Changes**.

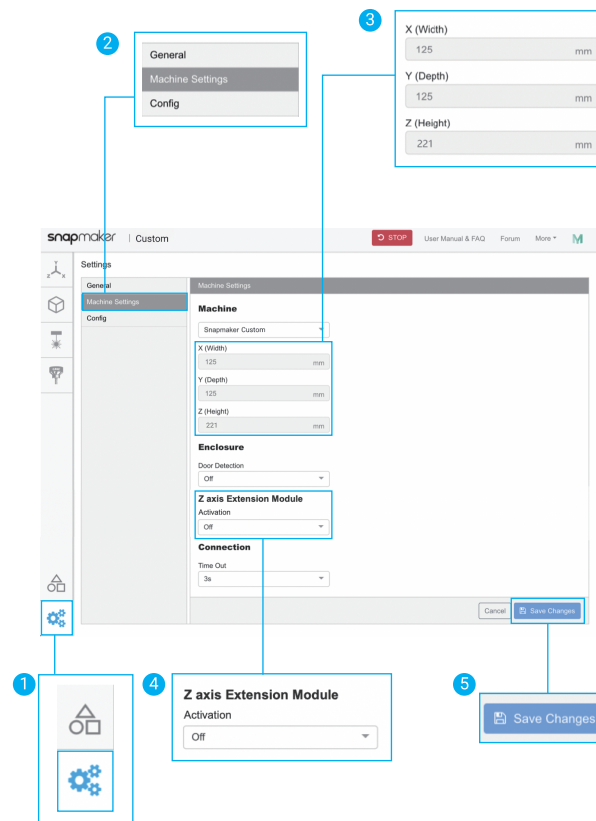

10

- 6 Tap **Controls** on the Touchscreen, and tap **Home Axes** to run a homing session.

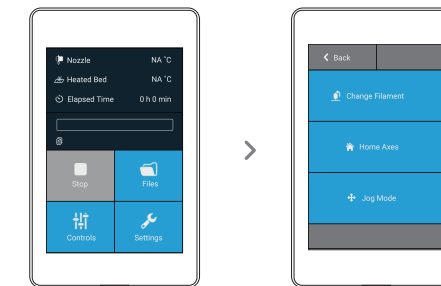

- 7 Level the Heated Bed. For detailed instructions, refer to Quick Start Guide. Your Z-Axis Extension Module is now ready to go.

Note: If your machine is using 3D printing Module, to see if configuration is successful, tap **Settings** -> **About** -> **Build Volume** on the Touchscreen.

Y.3.B.A.0021-01 V1.0.0

11